

Plotted By: Aponte, Alan    Sheet Set: CYPRESS LANDING CONDOMINIUM PARKING LOT    Layout: 06.00 LIFE SAFETY PLAN    March 04, 2025    10:12:44am    K:\FTL-Civil\044-Jobs\044203010-Cypress Nook\CAD\Plansheets - Cypress Nook\06.00 LIFE SAFETY PLAN.dwg

This document, together with the concepts and designs presented herein, as an instrument of service, is intended only for the specific purpose and client for which it was prepared. Reuse of and improper reliance on this document without written authorization and adaptation by Kimley-Horn and Associates, Inc. shall be without liability to Kimley-Horn and Associates, Inc.

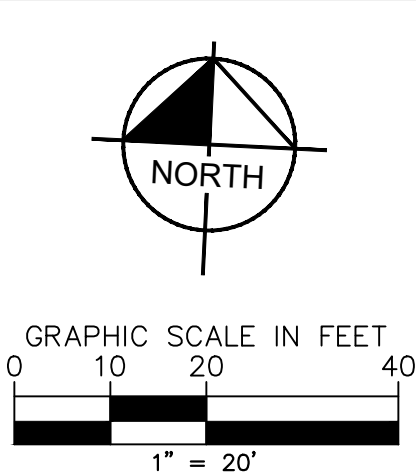
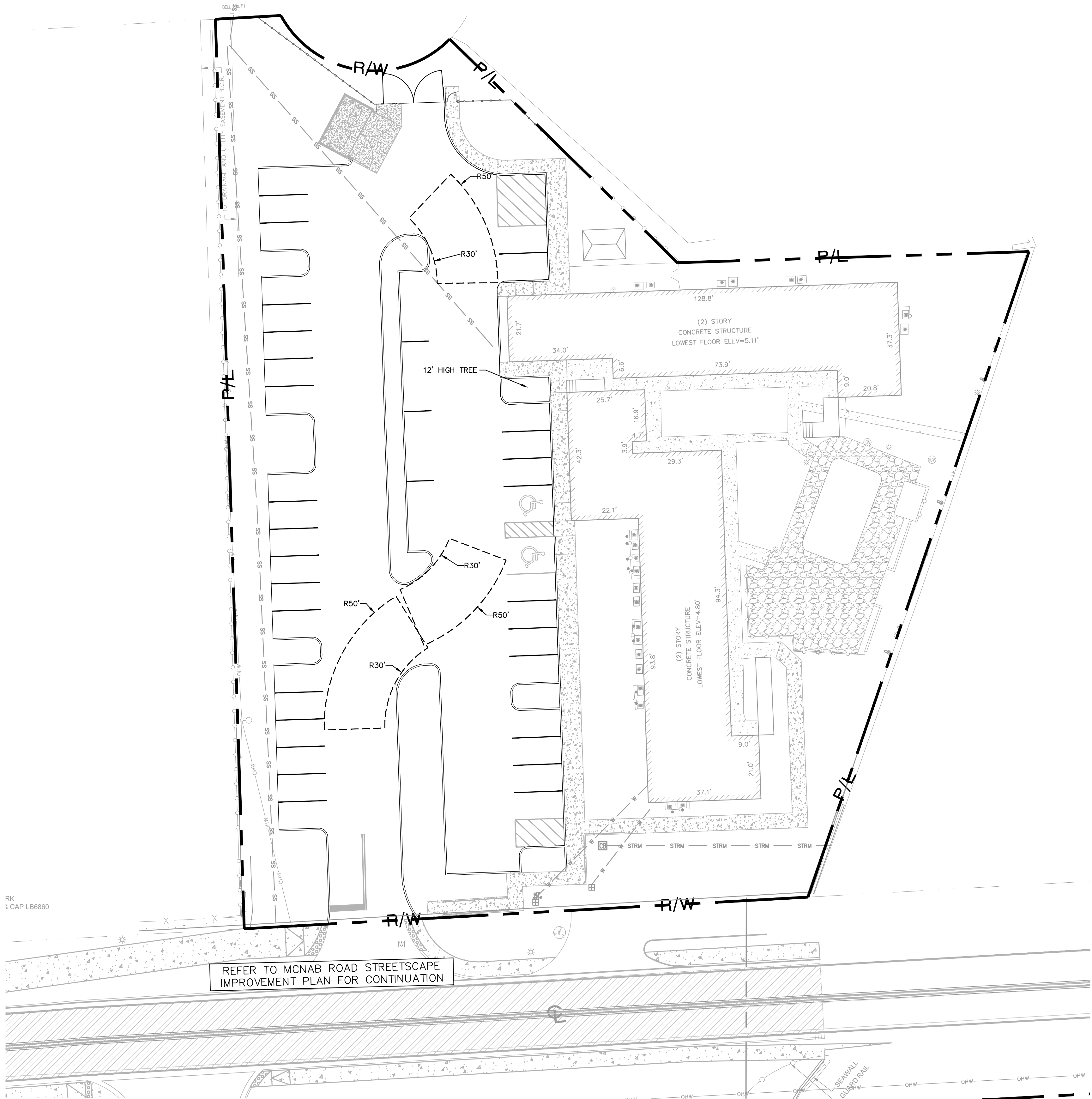

LEGEND

- CENTER LINE OF ROADWAY
- RIGHT-OF-WAY OR PROPERTY LINE

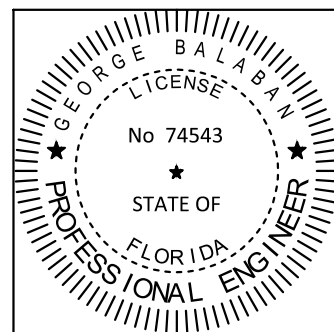

THE ITEM HAS BEEN DIGITALLY SIGNED AND SEALED BY  
GEORGE BALABAN ON THE DATE ADJACENT TO THE SEAL.

PRINTED COPIES OF THIS DOCUMENT ARE NOT CONSIDERED  
SIGNED AND SEALED AND THE SIGNATURE MUST BE VERIFIED  
ON ANY ELECTRONIC COPIES.

PLANS ARE IN NAVD 1988 DATUM  
CONVERSION EQUATION IS BELOW:  
(NAVD 1988) + 1.58' = (NGVD 1929)

THE PRESENCE OF GROUNDWATER SHOULD BE  
ANTICIPATED. CONTRACTOR'S BID SHALL  
INCLUDE CONSIDERATION FOR ADDRESSING THIS  
ISSUE AND OBTAINING ALL NECESSARY PERMITS.

Always call 811 two full business days before you dig!  
have underground utilities located and marked.

**Sunshine811.com**

**DRC**

PZ-25-12000006

CYPRESS LANDING CONDOMINIUM PARKING LOT		LIFE SAFETY PLAN		Kimley»Horn	
PREPARED FOR CITY OF POMPANO BEACH		KHA PROJECT 044203010		LICENSED PROFESSIONAL	
SHEET NUMBER C6.00		DATE FEB 2025		THOMAS C. HARGRETT, PLA	
		SCALE AS SHOWN		FL LICENSE NUMBER LA #6667512	
		DESIGNED BY TVC		DATE: 02/12/2025	
		DRAWN BY TVC		REVISIONS	
		CHECKED BY GB		No.	
				1 DRC SUBMITTAL	
				DATE	
				02/12/25 TVC	
				BY	